



High Temperature Pot Holding Systems

The following pots can work at elevated temperatures.

Style A pots, on the active face, have a countersunk hole and can be easily fixed using a countersunk screw.

Style B is a deep pot magnet that has an internal thread on the non-active face.

Style C is a deep pot magnet that has room for an internal thread to be machined in the non-active face if required (dim B)

Style D is Shallow Pot with a SmCo Disc in a Steel cup

Alnico High Temp Shallow Pot (Max Temp + 500°C)						
Dimensions (mm)						
Part Number	Style	ØD	Ød1	H	Tapered Screw	Holding Force (kg)
ALSP 00217	A	19.1	4.2	7.6	M4	3.0
ALSP 00218	A	28.6	5.2	8.7	M5	5.0
ALSP 00219	A	38.1	5	10.6	M5	13.0
Supplied Magnitised and Kepered						

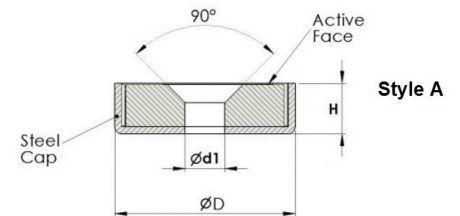

Alnico High Temp Deep Pot (Max Temp + 500°C)						
Dimensions (mm)						
Part Number	Style	ØD	H	Ød1	Holding Force (kg)	
ALDP 00547	B	17	16	M6	2.5	
ALDP 00983	B	27	25.5	M6	6.1	

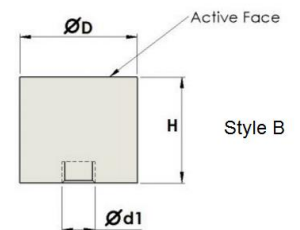

Samamium Cobalt Deep Pot (Max Temp +150°C)						
Dimensions (mm)						
Part Number	Style	ØD	H	B	Holding Force (kg)	
SMDP 00100	C	6	20	10	0.6	
SMDP 00101	C	8	20	10	1.0	
SMDP 00102	C	10	20	8	4.0	
SMDP 00103	C	13	20	6	6.0	
SMDP 00104	C	16	20	2	12.5	
SMDP 00163	C	20	25	5	25.0	
SMDP 00105	C	25	35	7	40.0	
SMDP 00164	C	32	40	5	60.0	

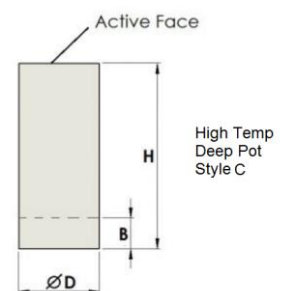

Samamium Cobalt Shallow Pot (Max Temp +150°C)						
Dimensions (mm)						
Part Number	Style	ØD	H	Holding Force (kg)		
SMSP 00106	D	6	4	0.5		
SMSP 01475	D	8	4.5	1.1		
SMSP 00107	D	10	5	2.0		
SMSP 00165	D	13	5	4.0		
SMSP 00166	D	17.5	5	6.0		
SMSP 00137	D	25	9	15.0		

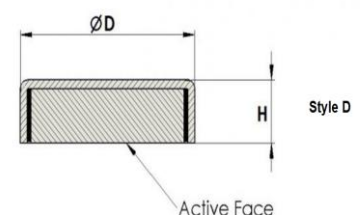

Please note:

Holding Forces are based upon direct contact with a thick, clean mild steel surface. Holding Forces will be reduced with heavily painted or corroded surfaces.

Before selecting a choice of holding system please consider the working environment of your application.

Magnet Sales & Service Limited
Unit 31 Blackworth Industrial Estate,
Highworth, Wilts SN6 7NA UK

Tel: +44 (0)1793 862100
Fax: +44 (0)17993 862101
sales@magnetsales.co.uk
www.magnetsales.co.uk



Certificate No 2346