



# SmCo

## Sintered Anisotropic Samarium Cobalt – Discs/Rods

Used extensively in tooling, sensor triggering and applications requiring a powerful magnet in hostile environments.

In all cases the height is the preferred magnetic axis.

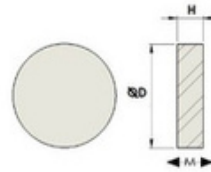
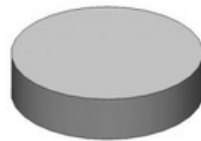

General Tols +/-0.2

Samarium Cobalt Discs/rods		
Part Number	ØD (mm)	H (mm)
SMDC 00937	1.5	1.9
SMDC 01679	1.778	1.905
SMDC 01247	2	5.5
SMDC 01248	2.3	0.8
SMDC 00732	2.3	1.3
SMDC 00535	2.3	1.8
SMDC 00855	2.7	4
SMDC 00893	2.7	4.5
SMDC 00382	3	1.5
SMDC 00116	3	2
SMDC 01390	3.17	2.9
SMDC 01079	3.17	5
SMDC 00682	3.17	8.71
SMDC 00773	4.2	2
SMDC 00818	4.5	2.5
SMDC 01493	4.9	5.9
SMDC 01454	5	1.5
SMDC 00117	5	2
SMDC 00118	5	3
SMDC 00263	5	5
SMRD 00952	5	10
SMDC 00325	6	4
SMDC 00309	6	6
SMRD 01417	6	12
SMDC 00465	6.35	2.5
SMDC 00119	7	3
SMDC 00476	7	5
SMDC 01023	7	7
SMRD 00951	7	10

Samarium Cobalt Discs/rods		
Part Number	ØD (mm)	H (mm)
SMRD 02437	8	5
SMDC 00833	9	2
SMDC 00265	9	3
SMDC 00266	9	5
SMRD 00978	9	10
SMDC 00267	10	3
SMDC 00268	10	5
SMRD 01266	10	10
SMDC 02128	11.2	16
SMDC 02287	12	13
SMDC 01427	12.5	3.5
SMDC 00269	12.5	5
SMDC 00270	15	3
SMDC 00271	15	5
SMDC 00899	19	4.5
SMDC 00953	19	7
SMDC 00272	20	5
SMDC 02282	20	20
SMDC 01623	22	13
SMDC 01344	25	5
SMDC 00273	25	7
SMDC 01505	25	12.7
SMDC 01151	32	15
SMDC 01587	34	13
SMDC 01588	34	26